

LEGAL NOTICE NO. 163

REPUBLIC OF TRINIDAD AND TOBAGO

THE FORESTS ACT, CHAP. 66:01

ORDER

MADE BY THE MINISTER UNDER SECTION 2 OF THE FORESTS ACT

THE FORESTS (PROHIBITED AREAS) ORDER, 1998

1. This Order may be cited as the Forests (Prohibited Areas) Citation Order, 1998.

2. The Forest Reserves referred to in the Schedule and delineated ^{Prohibited} in the respective plans at Appendices 1–15 are hereby declared ^{areas} prohibited areas until 30th June, 1998.

SCHEDULE

Arena Reserve	(Appendix 1)
Arima Reserve	(Appendix 2)
Blanchisseuse Reserve	(Appendix 3)
Brigand Hill Reserve	(Appendix 4)
Ecclesville Windbelt Reserve	(Appendix 5)
Las Cuevas Reserve	(Appendix 6)
Nariva Windbelt Reserve	(Appendix 7)
Northern Range Reserve "A"	(Appendix 8)
Northern Range Reserve "B"	(Appendix 9)
Northern Range Reserve "C"	(Appendix 10)
Paria Reserve	(Appendix 11)
Tacarigua Reserve	(Appendix 12)
Todd's Road North Forest Reserve	(Appendix 13)
Todd's Road South Forest Reserve	(Appendix 14)
Yarra Reserve	(Appendix 15)

Made this 4th day of May, 1998.

R. MOHAMMED
*Minister of Agriculture,
 Land and Marine Resources*

PLAN

APPENDIX 1

OF THE

ARENA RESERVE

IN THE COUNTY OF CARONI
SURVEYED BY J. G. REECE

AREA 3797 - 0 - 0

SCALE - 1 IN 50000

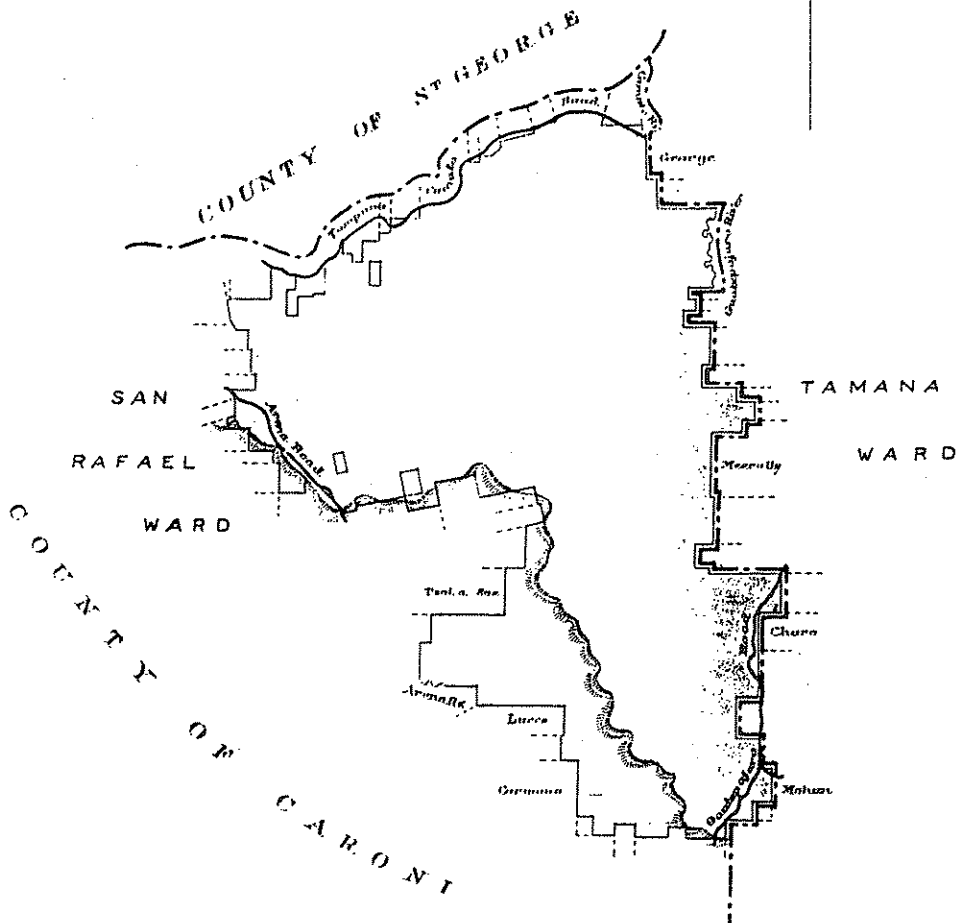
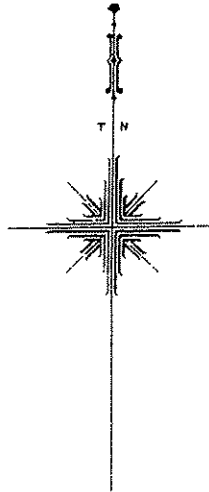

C. S. ROGERS,
Comptroller of Forests.

County Boundaries shown - - - -

October, 1921.

APPENDIX 2

PLAN

OF THE

ARIMA RESERVE

IN THE COUNTY OF ST GEORGE
SURVEYED BY J. W. OUMANOIRE

AREA - 1830 ACRES (APPROX)

SCALE 40 CHAINS TO AN INCH

T
A
C
A
R
I
G
U
A

A
R
I
M
A

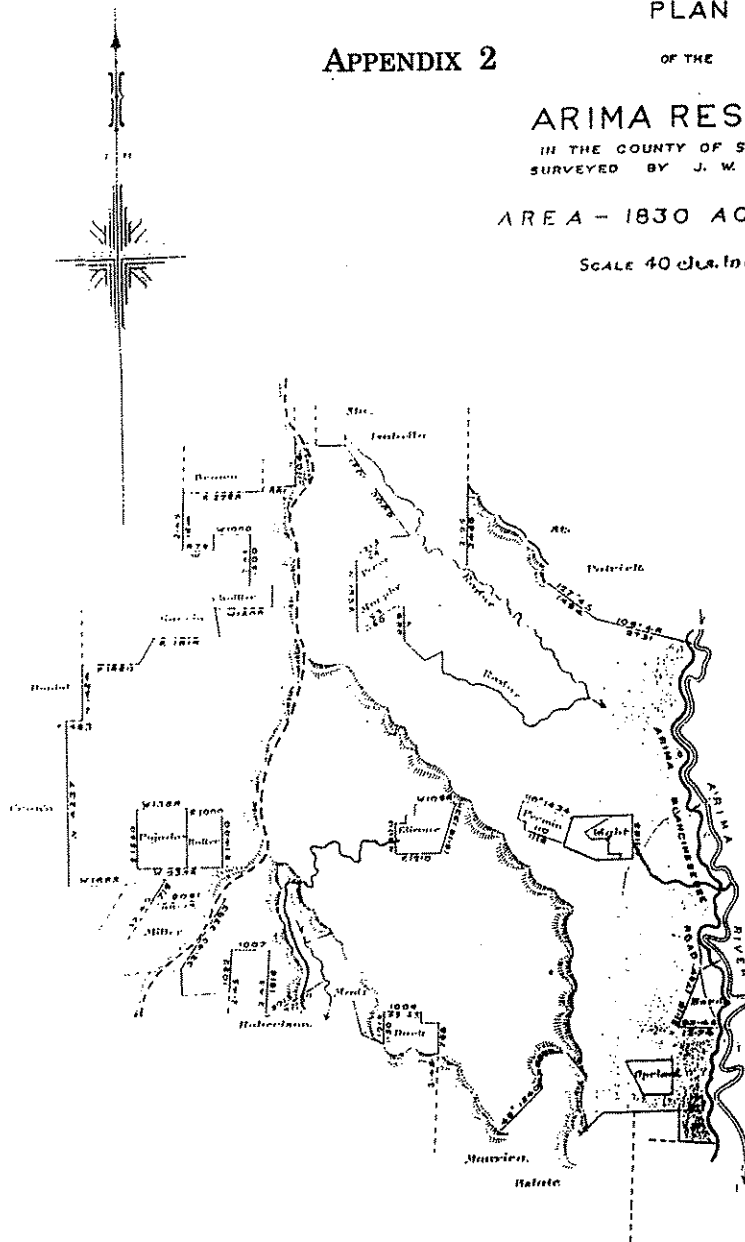

Ward Boundaries shown - - - - -

O. S. ROGERS,
Conservator of Forests

October, 1921.

APPENDIX 3

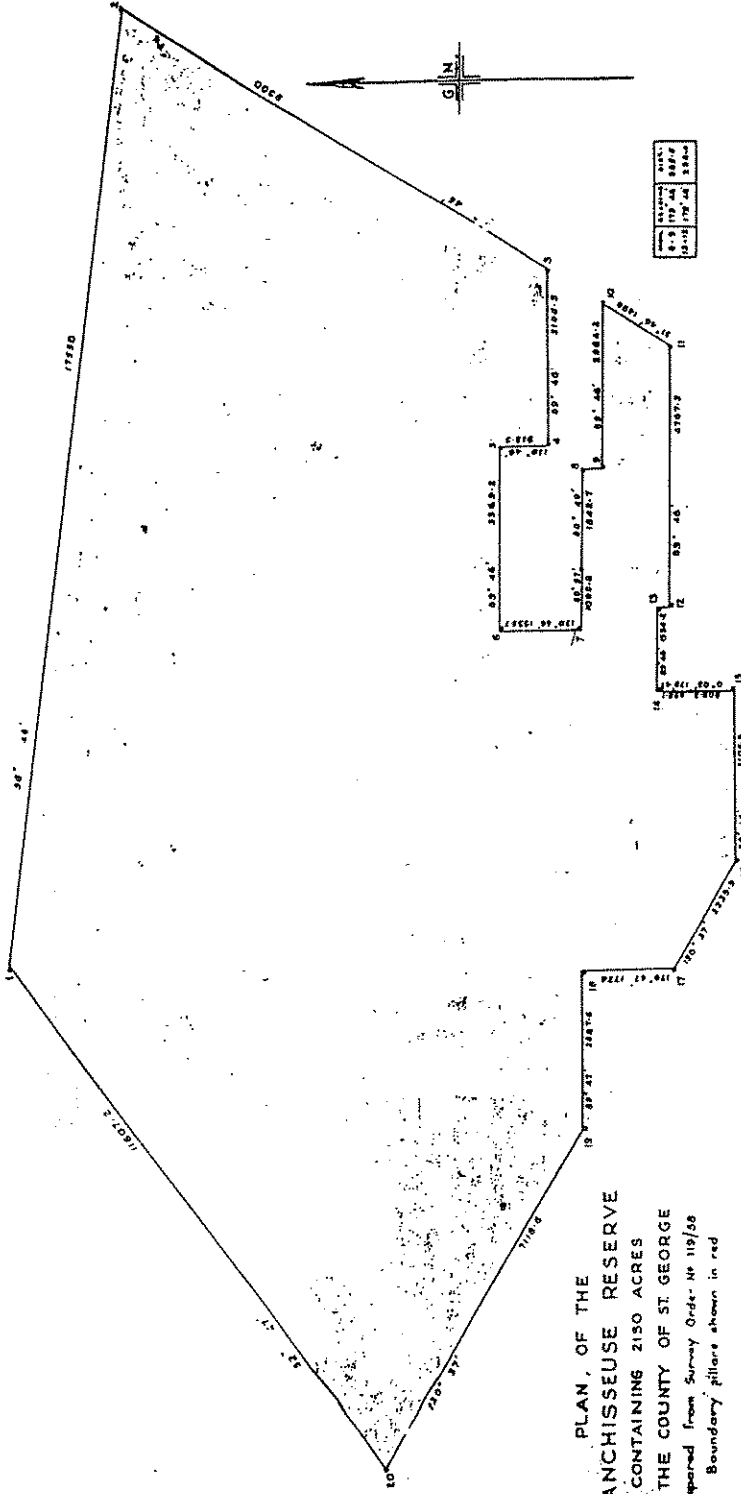

Handwritten signature and date:
 9th July 1988

" APPENDIX 5

PLAN OF THE
ECCLESVILLE WINDBELT
RESERVE
CONTAINING
A 1277 R O P
IN THE COUNTY OF NARIVA

Surveyed by W. E. Reace in 1934
(S.O. 10/34)



Boundary Pillars numbered in red

To obtain Compass Bearings add 12 Minutes

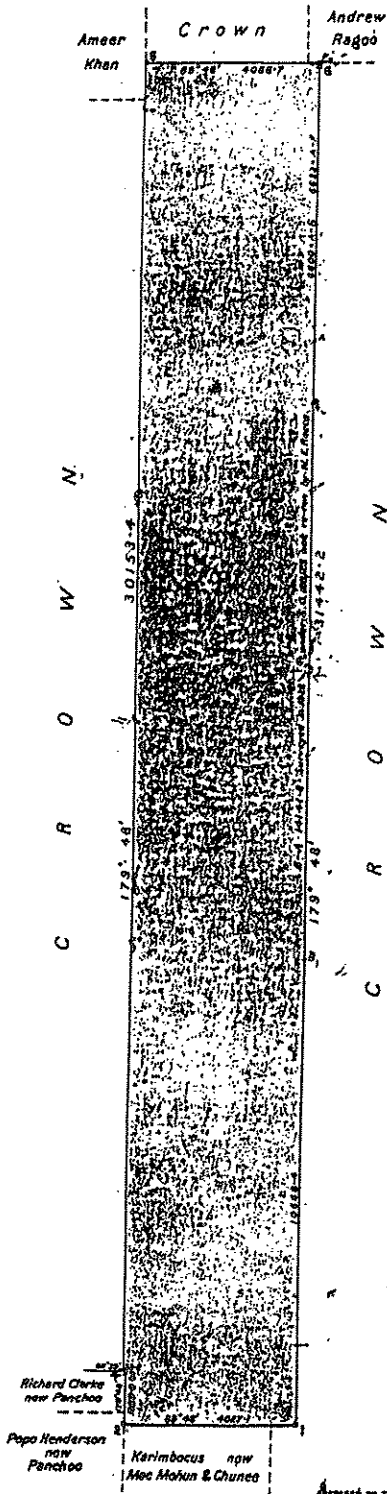
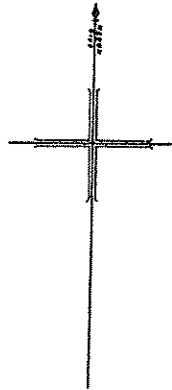

R. L. Brooks J. W. Macgillivray
Ag. Conservator of Forests Surveyor-General
31. 8. 34 30. 8. 34

APPENDIX 6

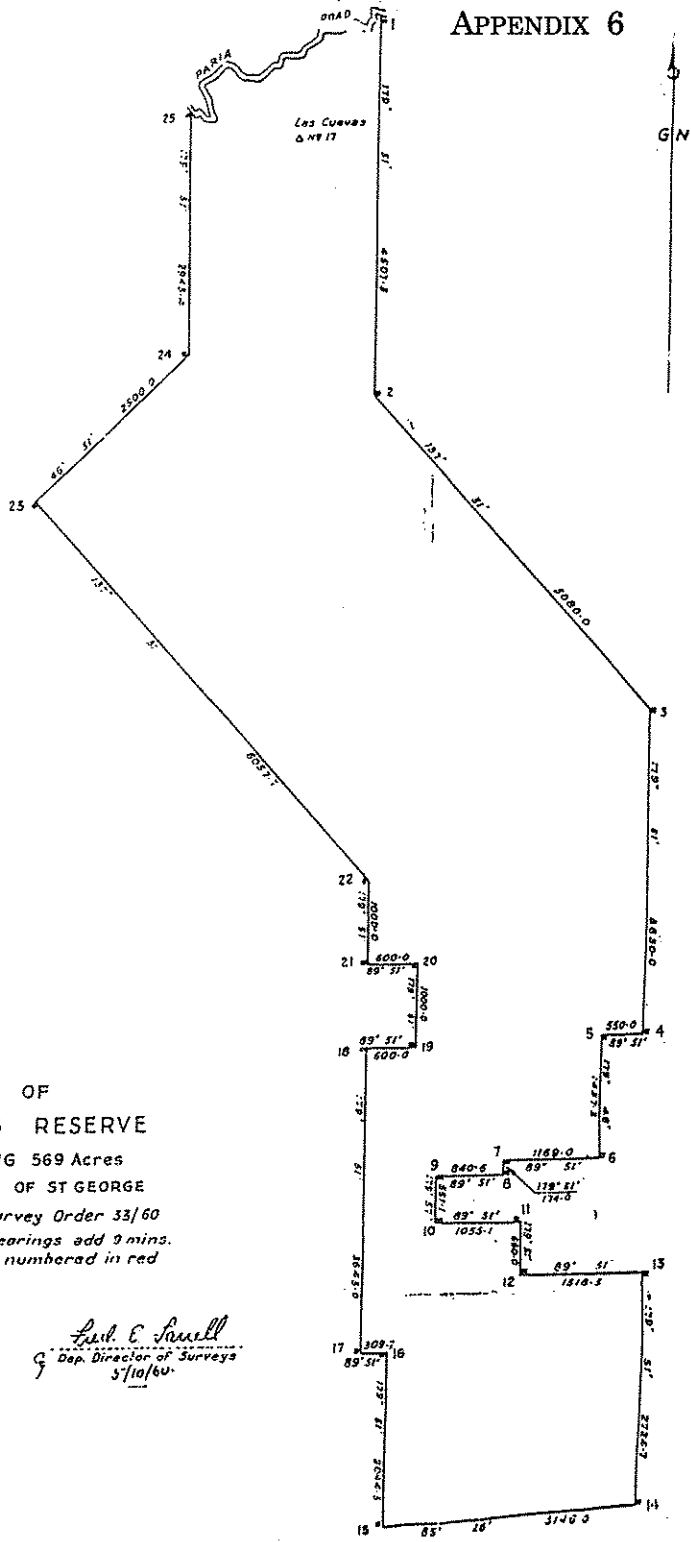

MAP OF
LAS CUEVAS RESERVE
CONTAINING 569 Acres
IN THE COUNTY OF ST GEORGE

Prepared from Survey Order 33/60
To obtain compass bearings add 9 mins.
Boundary Pillars numbered in red

[Signature]
Conservator of Forests
1-6-66

[Signature]
Dep. Director of Surveys
5/10/60

APPENDIX 7

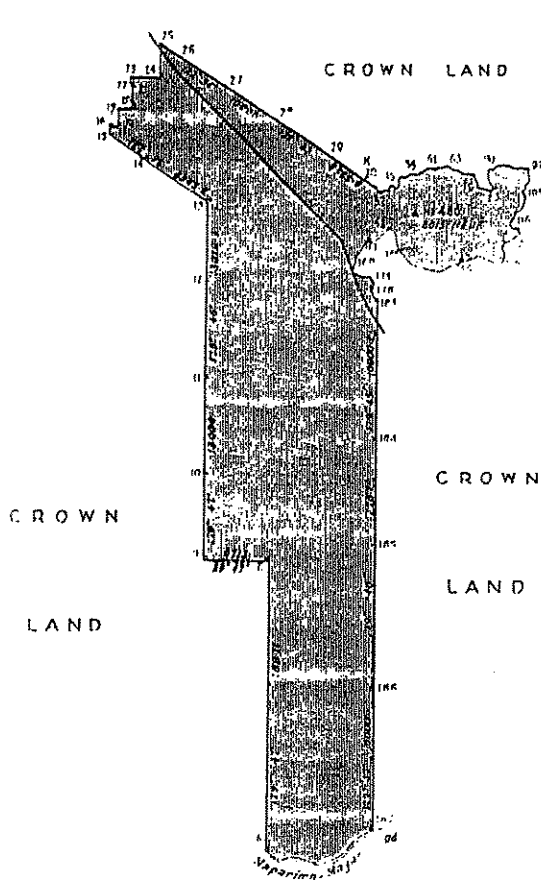

Bearings	Dist
112° 46'	180.7
90° 00'	255.7
89° 46'	103.0
119° 45'	1740.8
110° 46'	1482.4
91° 11'	44.1
110° 46'	380.0
88° 46'	7032.0
119° 46'	7404.9

PLAN OF THE
 NARIVA WINDBELT RESERVE
 CONTAINING
 6267 Acres
 IN THE COUNTY OF NARIVA

Surveyed by Messrs. W. Reece and V. Turpin in 1935
 Survey Orders 19/23 & 47/35

To obtain compass bearings add 12 to 15 mins.
 Boundary marks shown in red.

W. Reece
 Commissioner of Forests
 10.4.1935

V. Turpin
 Chief Director of Surveys
 4/4/35

APPENDIX 8

BLANCHISSEUSE WARD

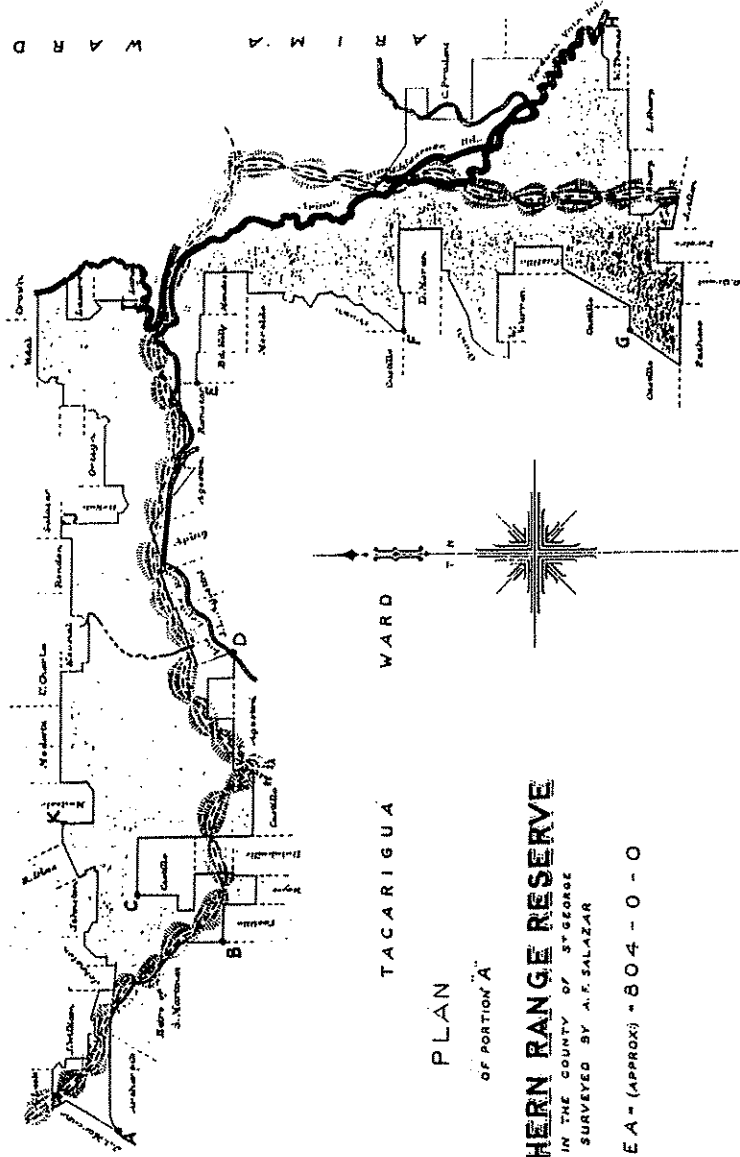

TACARIGUA WARD

PLAN OF PORTION 'A'

NORTHERN RANGE RESERVE

IN THE COUNTY OF ST. GEORGE SURVEYED BY A.F. SALAZAR

AREA - (APPROX) * 804 - 0 - 0

C. S. ROGERS, Conservator of Forests, October, 1921.

APPENDIX 10
 PLAN
 OF PORTION "C"
 NORTHERN RANGE RESERVE
 IN THE COUNTY OF ST. GEORGE
 SURVEYED BY A. F. SALAZAR
 AREA - 239 - 2 - 13

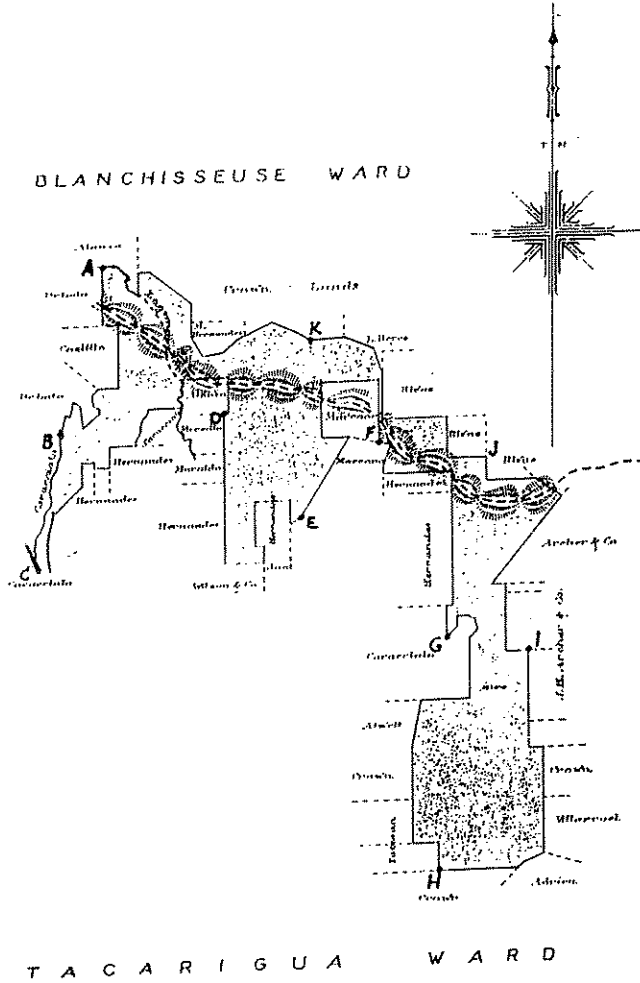

Ward boundaries shown by -----

G. S. ROGERS,
 Conservator of Forests.
 October, 1921.

APPENDIX 12

PLAN OF THE
TACARIGUA RESERVE
CONTAINING
1749 ACRES
IN THE COUNTY OF ST. GEORGE

Prepared from Survey Order
To obtain compass bearings and 6, 7, 8 and 9 minutes
Boundary pillars shown in red.

Clarence Long
Conservator of Forests
21/10/97

X. J. ...
As Director of Surveys
18/7/98

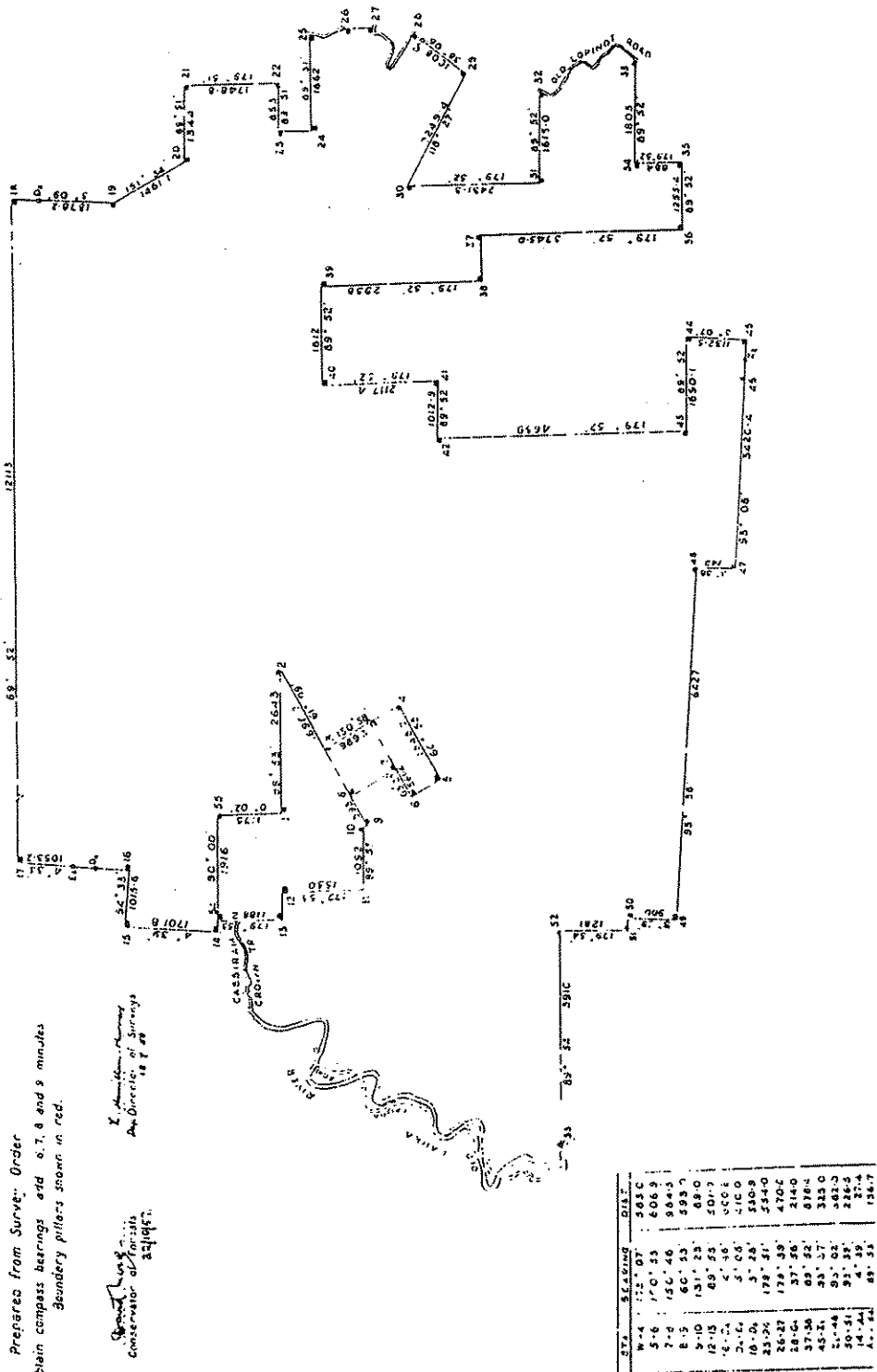

APPENDIX 15

PLAN OF THE
YARRA RESERVE
CONTAINING 1578 ACRES
IN THE COUNTY OF ST GEORGE

Prepared from Survey Order No 20350
To obtain compass bearings add 11 & 12 mins
Boundary pillars shown in red

D. A. ...
By Conservator of Forests
2/ 11/ 59

Frank E. Russell
By Director of Surveys
17/11/59

